

# VIPP11W TOILET BRUSH WALL MOUNTED

## DESIGNER

Vipp Design Lab, 2010

## COUNTRY OF ORIGIN

Design: Denmark

Production and assembly: PRC



## PRODUCT DESCRIPTION

The toilet brush can be easily removed from and placed on the wall bracket, which is equipped with a locking mechanism. The brush head and inner tube can be replaced. A rubber ring at the top ensures that the brush fits tightly.

Together with the wall-mounted soap dispenser, the toilet brush creates a complete look in the bathroom.

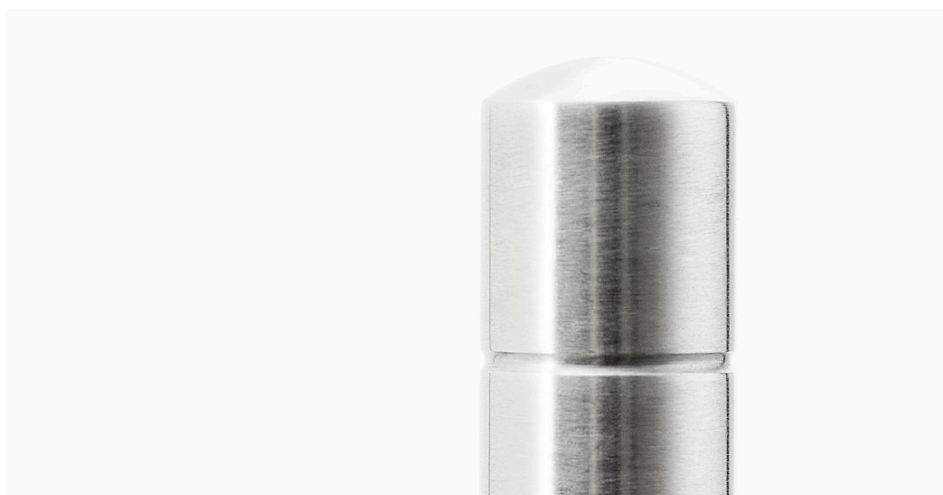

## CARE INSTRUCTIONS

Stainless steel surfaces should be cleaned and polished with a microfiber cloth, glass cleaner or other non-abrasive and gentle cleaning agents.

Lacquered surfaces should be cleaned with a moist cloth.

The inner tube can be removed for cleaning. The brush head can be replaced and purchased separately. Find your nearest dealer at [www.vipp.com](http://www.vipp.com).

Vipp products with dark surfaces should be cleaned with a soft brush and, if stained, with a bit of water. Then wipe with dry cloth.

The Handle of the Vipp toilet brush is in high grade stainless steel. To uphold a high resistance against corrosion cleaning agents containing chlorine should not be used.

## WARRANTY

2 years warranty. The warranty presupposes rightful use as described in Vippps care instructions, with reservations for normal wear and tear. Please see Vippps care instructions below or at [www.vipp.com](http://www.vipp.com)

# VIPP11W

## TOILET BRUSH

### WALL MOUNTED

#### MATERIALS

Black: metallic powder coating

White: White powder coating (RAL 9016)

Stainless steel: Polished

Limited edition 2011: Powder coated  
(NCSS 0580 Y90R)

#### MANUFACTURING

Brush: Nylon

Handle Top; polished stainless steel (AISI 304)

Handle bottom; polished stainless steel  
(AISI 316)

Top dome; Polished stainless steel (AISI 304)

Top ring; Rubber

Inner tube; Poly carbonate

Body: Powder coated galvanized steel/  
polished stainless steel (AISI 304)

Bottom: Rubber

Mounting bracket: Rubber coated poly-  
propylene

#### DIMENSIONS & WEIGHT

Height: 33 cm

Diameter: ø9cm

#### VERSIONS

Black (CWS 85609 Schwarz metallic)

White (CWS 9898849 RAL 9016)

#### PACKAGING/FSC

Brown cardboard box: 74,7 cm x 46,1 cm  
x 46,1 cm

EPS foam insert

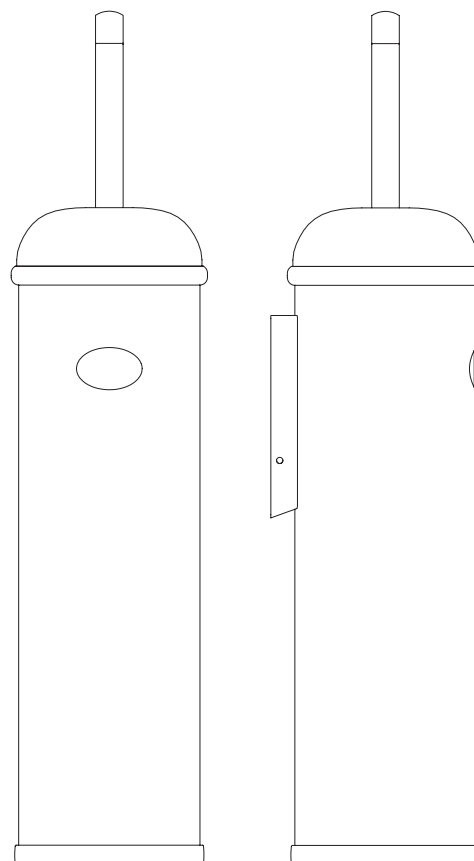
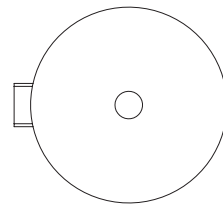

# VIPP11W

## MOUNTING INSTRUCTIONS



### DRILL SIZE

ø 6mm



### DRILLING DISTANCE

68mm



### BRICK/CONCRETE RAWLPLUGS

Please make sure to choose rawlplugs according to the material on which you want to place the product. Substitute enclosed rawlplugs with another type if needed.

1 - Drill holes and place rawlplugs.

2 - Mount bracket using screws.

3 - Place the product onto the bracket. The product is now ready for use. The product can be taken off the bracket and put back on as needed.

### SECURITY FEATURE

Tighten the integrated screw on the product with the enclosed custom tool. The product is now locked to the bracket.

